

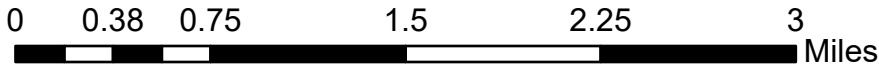

Volunteer Wildlife Monitoring Program (VWMP) Frog and Toad Survey

Inactive Route Map Route ID: 360122 County: Page

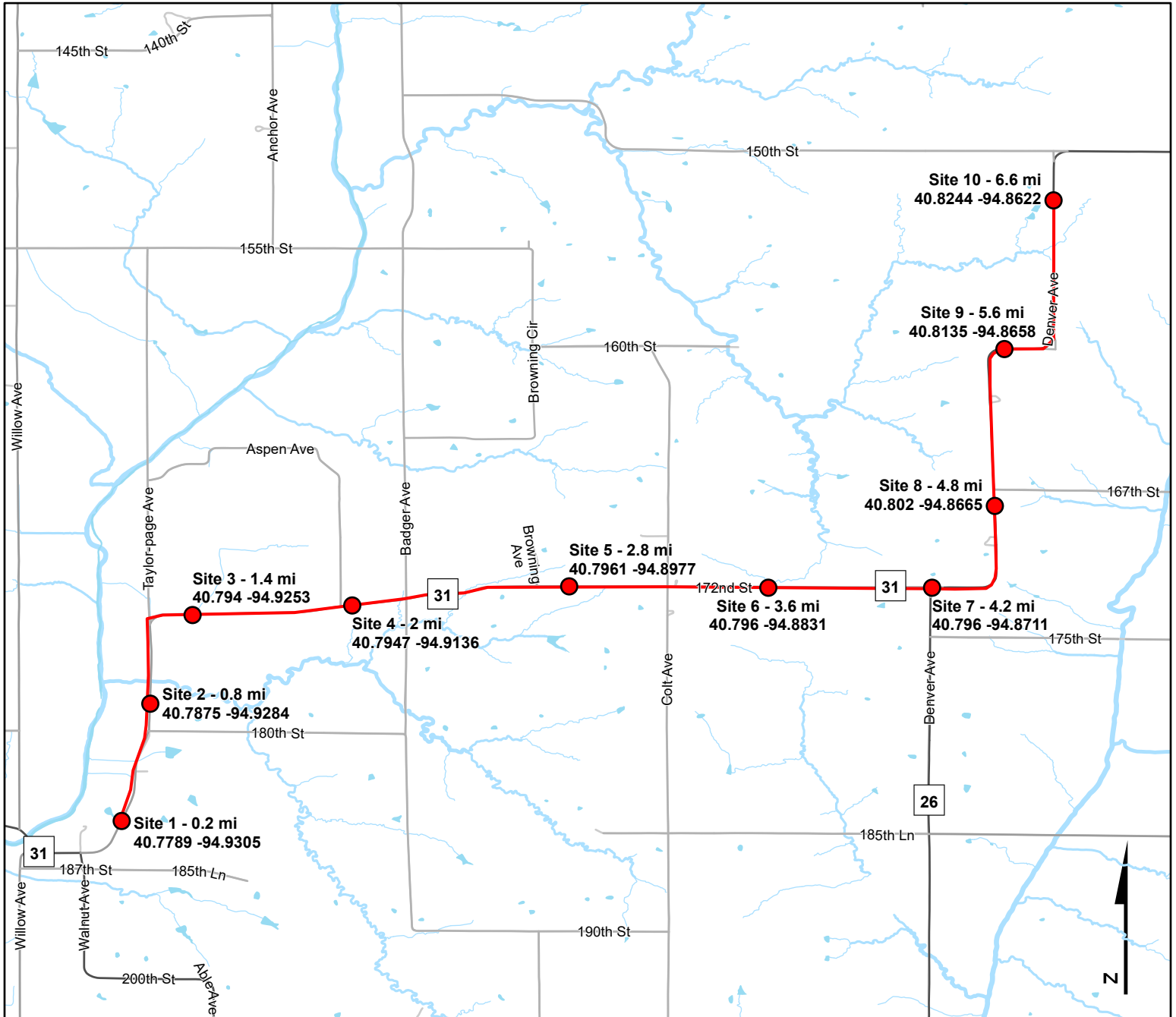

- Frog and Toad Survey Sites
- Frog and Toad Survey Route



Questions? Contact the VWMP Coordinator at vwmp@dnr.iowa.gov.

Created on: 4/4/2019





Volunteer Wildlife Monitoring Program (VWMP) Frog and Toad Survey

Inactive Route Table Route ID: 360122 County: Page



SiteNum	Site_Name	Directions
1	0.2	Drive 0.2 miles from start point at the corner -Drive north on Taylor-Page Ave. Pond with rim of grass on left (west)side with 1 willow tree.
2	0.8	Continue north on Taylor-Page Ave. past 180th. Small pool/marshy area/wooded stream on right (east) side of the road. Large willow growing in the pool.
3	1.4	Take a right onto 172nd St. Stop at deep ditch and winding grassy stream on left (north)side of the road. Winds through crop fields.
4	2	Continue east on 172nd. Stop just after passing Aspen Rd. on north. Ponds on both sides of the road.
5	2.8	Continue east on 172nd. Stop is shortly after passing Browing Ave. It is a larger pond on the south side in a valley -long and narrow. Watch where you stop here!
6	3.6	Continue east on 172nd. Stop is at small seep/wet area leading to a stream on the left side of the road. In a pasture, trees around it, lower than road. Land on right is cropped and rising.
7	4.2	Continue east on 172nd. Stop at intersection with Denver Ave. going south. Small pond in pasture bowl on left side of road.
8	4.8	Follow road as it curves to the north. Stop just before you get to 167th. Pond in pasture on right (east)side of road.
9	5.6	Continue north. Stop directly after road curves to the east. There are a couple of ponds and marshy areas on the left side of road partially hidden from view, trees and cttails surround pond.
10	6.6	Follow road as it curves back north. Stop just before road curves to the east - 4 ponds in pasture on the left side (west)of road.



Frog and Toad Call Survey Route Description

Route ID **360122**

Established:

Site Number	Name	County	Latitude	Longitude	Directions
1	0.2	Page	40.7789001	-94.9304962	Drive 0.2 miles from start point at the corner -Drive north on Taylor-Page Ave. Pond with rim of grass on left (west)side with 1 willow tree.
2	0.8	Taylor	40.7874985	-94.9283981	Continue north on Taylor-Page Ave. past 180th. Small pool/marshy area/wooded stream on right (east) side of the road. Large willow growing in the pool.
3	1.4	Taylor	40.7939987	-94.9253006	Take a right onto 172nd St. Stop at deep ditch and winding grassy stream on left (north)side of the road. Winds through crop fields.
4	2	Taylor	40.7947006	-94.9135971	Continue east on 172nd. Stop just after passing Aspen Rd. on north. Ponds on both sides of the road.
5	2.8	Taylor	40.7961006	-94.8976974	Continue east on 172nd. Stop is shortly after passing Browing Ave. It is a larger pond on the souths side in a valley -long and narrow. Watch where you stop here!
6	3.6	Taylor	40.7960014	-94.8831024	Continue east on 172nd. Stop is at smalls seep/wet area leading to a stream on the left side of the road. In a pasture, trees around it, lower than road. Land on right is cropped and rising.
7	4.2	Taylor	40.7960014	-94.8711014	Continue east on 172nd. Stop at intersection with Denver Ave. going south. Small pond in pasture bowl on left side of road.



Frog and Toad Call Survey Route Description

8	4.8	Taylor	40.8019981	-94.8665009	Follow road as it curves to the north. Stop just before you get to 167th. Pond in pasture on right (east)side of road.
9	5.6	Taylor	40.8134995	-94.865799	Continue north. Stop directly after road curves to the east. There are a couple of ponds and marshy areas on the left side of road partially hidden from view, trees and cttails surround pond.
10	6.6	Taylor	40.8244019	-94.8621979	Follow road as it curves back north. Stop just before road curves to the east - 4 ponds in pasture on the left side (west)of road.